

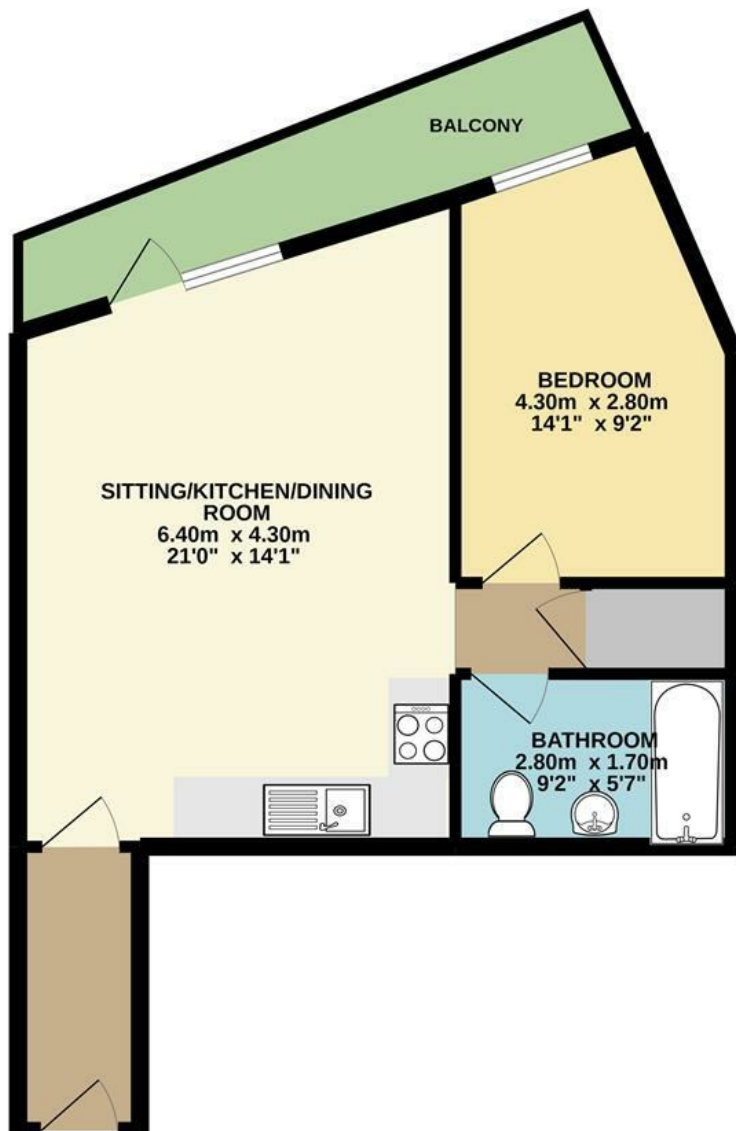

Paper Mill Yard | Norwich | NR1
Offers In Excess Of £170,000

abbotFox

GROUND FLOOR
45.6 sq.m. (491 sq.ft.) approx.



TOTAL FLOOR AREA : 45.6 sq.m. (491 sq.ft.) approx.

Whilst every attempt has been made to ensure the accuracy of the floorplan contained here, measurements of doors, windows, rooms and any other items are approximate and no responsibility is taken for any error, omission or mis-statement. This plan is for illustrative purposes only and should be used as such by any prospective purchaser. The services, systems and appliances shown have not been tested and no guarantee as to their operability or efficiency can be given.
Made with Metropix ©2022

Energy Efficiency Rating		Current	Potential
Very energy efficient - lower running costs			
(92 plus) A			
(81-91) B			
(69-80) C			
(55-68) D			
(39-54) E			
(21-38) F			
(1-20) G			
Not energy efficient - higher running costs			
England & Wales		EU Directive 2002/91/EC	

Disclaimer – In accordance with the Property Misdescriptions Act, the company gives notice that all descriptions, references to condition, necessary permissions for use and other details are given in good faith and believed to be correct, but any intending lessees do not rely on them as statements of fact, but must satisfy themselves by inspection or other means, as to their accuracy.



abbotFox presents this stylish, purpose built apartment. Located within the popular Paper Mill Yard development, this home has been thoughtfully improved by the current owner. With a generous, private terrace, and stylish open plan living this home is an ideal opportunity for any first time buyer or buy-to let investor. With the property offered to the market with no onward chain and offering secure, allocated parking an internal viewing comes highly recommended.

